

SEENYEM NEW YORK APPROVED INCANDESCENT EMERGENCY LIGHTING

Emergensee
Lighting Products, Inc.
America's Leader in Life-Safety Lighting Products



FEATURES

- Heavy duty construction
- NY approved housing
- UL listed for damp locations & meets UL924, NFPA 101 Life Safety Code, NEC, OSHA, Local and State Codes

ELECTRICAL

- Dual 120V/277V voltage
- Remote Capability available on 12V model
- Charge rate/power "ON" LED indicator light and push-to-test switch for mandated code compliance testing
- LVD (low voltage disconnect) prevents battery from deep discharge
- 6V, sealed lead acid, maintenance-free, rechargeable battery
- Internal solid-state transfer switch automatically connects the internal battery to lamp heads for minimum 90-minute emergency illumination
- Fully automatic solid-state, two-rate charger initiates battery charging to recharge a discharged battery in 24 hours

HOUSING

- Heavy 20-gauge steel construction
- White powder-coated finish
- Side and top conduit knockouts
- White or Black finish
- Thermoplastic emergency lamp heads

ILLUMINATION

- Adjustable, glare-free PAR-Type lamp heads
- Optional 3rd head included
- 6V model offers 9W lamps, standard
- 12V model offers 12W lamps, standard
- Remote Capability available on 12V model

WARRANTY & LISTINGS

- Five Year Warranty on all electronics and housing. Batteries are pro-rated warranted for 5 years.

DIMENSIONS

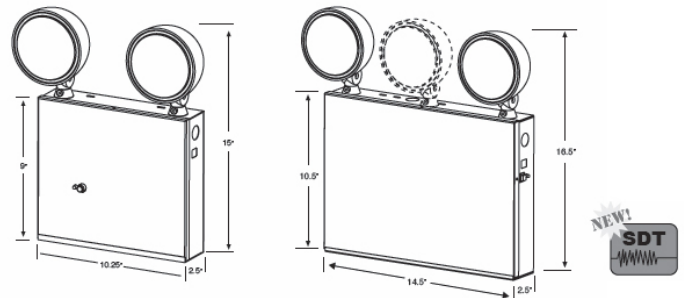

ORDERING INFORMATION

Sample Part Number: **SEENYEM-12-3-50-12-RC**

MODEL	VOLTAGE	# OF HEADS	UNIT WATTAGE	LAMP WATTAGE	OPTIONS	HOUSING COLOR
SEENYEM	6 - 6V	2 - TWO HEADS	18 - 18W	9 - 9W	NONE	BLANK - WHITE B -BLACK
	6 - 6V	3 - THREE HEADS	27 - 27W	9 - 9W	NONE	
	12 - 12V	3 - THREE HEADS	50 - 50W	12 - 12W	RC - REMOTE CONTROL (50W ONLY)	

NOTE: Product specifications subject to change without notice. Updated 08.2017