

Job Name: _____

Type: _____

Part #: _____

Notes: _____

PBOSFRL

EasyLED Square Bollard with LED Cone Reflector

HOUSING

- Extruded Aluminum Housing with Flush Mounting Base & Vandal-Resistant Screws, Flat Top, Powdercoat Finish Over a Chromate Conversion Coating, Internal Ballast Tray for Easy Maintenance

REFLECTOR

- Specially Designed Aluminum Cone Reflector for LED

LENS

- Clear Polycarbonate Lens

MOUNTING

- Mounting kit with 8" anchor bolts (included).

LUMAFIT LED

- Array Lumens: 2,089
- Delivered Lumens: 1,382
- CRI: 83
- CCT: 4000K, 5000K
- Rated Life: 50,000 Hours
- 5-Year Warranty
- Aluminum Boards

WATTAGE

- Array: 14.5w, System: 17w

DRIVER

- Electronic Driver, 120-277V, 50/60Hz
- Dimmable Driver

OPTIONS

- Surge Protection
- Battery Backup
- Bollards Can Be Cut To Custom Lengths Upon Request
- Custom Colors Available on Request

WARRANTY & LISTINGS

- CSA: Listed for Wet Locations. IP65
- Operating Temperatures: -40°C to +40°C



DIMENSIONS

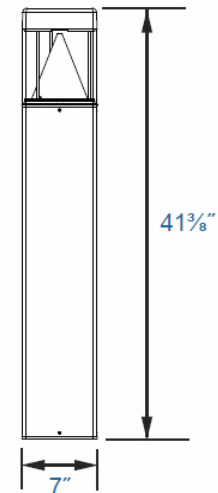

ORDERING INFORMATION:

MODEL	OPTICS	# OF ARRAYS	WATTAGE	BALLAST	CCT	COLOR	OPTIONS
PBOSFRL	F	1X	15	U			
	Medium Beam Spread	One	15W	120-277V	4K=4000K 5K=5000K	Z=BRONZE B=BLACK	SF=SINGLE FUSE DF=DOUBLE FUSE SP=SURGE PROTECTION

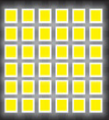

Job Name: _____

Type: _____

Part #: _____

Notes: _____

OPTIONS

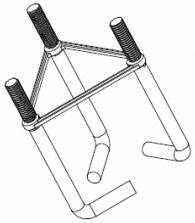

BOLAN

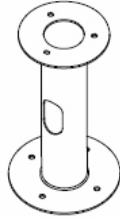

BOLRM

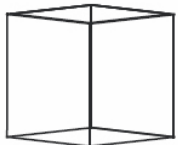

BOLPCS



3EBL120277

CATALOG #	DESCRIPTION
BOLAN4	MOUNTING KIT, INCLUDES BRACKET & (3) 4" ANCHOR BOLTS
BOLAN8	MOUNTING KIT, INCLUDES BRACKET & (3) 8" ANCHOR BOLTS
BOLAN12	MOUNTING KIT, INCLUDES BRACKET & (3) 12" ANCHOR BOLTS
BOLAN15	MOUNTING KIT, INCLUDES BRACKET & (3) 15" ANCHOR BOLTS
BOLPC	REPLACEMENT POLYCARBONATE LENS
BOLRM	ROOT MOUNT KIT
3EBL120277	PROVIDES 90 MINUTES OF BACKUP POWER

PHOTOMETRIC

