

**Job Name:** \_\_\_\_\_

**Type:** \_\_\_\_\_

**Part #:** \_\_\_\_\_

**Notes:** \_\_\_\_\_

## SEEINDEMR16 LED NEMA4X/NSF Emergency Unit

### STANDARD



### OPTIONAL



### ILLUMINATION

- Two fully adjustable, ultra bright 3.3 watt high performance MR-16 base LED lamp heads for optimized center-to-center spacing.

### ELECTRICAL

- Dual 120/277 voltage.
- Unique bi-color LED indicator light alerts occupant on battery condition (Green-normal, Red-check-battery).
- Charge rate/power "ON" LED indicator light and magnetic test switch for mandated code compliance testing.
- 6V/12V maintenance-free, rechargeable NiCd battery (15W models).
- 6V/12V maintenance-free, rechargeable sealed lead acid battery (36W and 54W models).
- Offers 7.8Wh, 28.8Wh, 46.8Wh of remote capacity (6V/12V DC output) standard on the 15W, 36W and 54W models.
- Internal solid-state transfer switch automatically connects the internal battery to LED lamp heads for minimum 90-minute emergency illumination.
- Fully automatic solid-state, two-rate charger initiates battery charging to recharge a discharged battery in 24 hours (36 hours on the 54W model).

### MOUNTING

- Universal knockout pattern on back provided with gasket for watertight seal for back mount.
- Suitable for wall mount.

### HOUSING

- Housing is reinforced polycarbonate construction in white or black finish. Corrosion-resistant enclosure with one piece, high-impact resistant, UV stabilized polycarbonate lens and molded gasket with stainless steel screws.
- Knockout's provided for conduit feed applications.

### OPTIONS

- SDT: Self-diagnostic feature performs monthly, biannual, and annual tests to ensure reliable operation and meets electrical and life safety codes.
- CW: Optional internal heater and battery blanket for extreme cold temperature applications (-25°C – 50°C).
- TP: Tamper-proof hardware helps discourage unauthorized access to the unit.

### WARRANTY / LISTING

- Five year warranty on all electronics and housing. Batteries prorated for two (lead acid) / five (NiCd) years.
- Meets UL924, NFPA101 Life Safety Code, NEC, OSHA, Local and State Codes.
- IP66 rated for Ingress protection.
- NEMA4X rated.
- UL certified for use in food service operations.
- UL listed for wet locations (0°C – 50°C on 15W and 10°C – 40°C on 36W / 54W models).

### DIMENSIONS

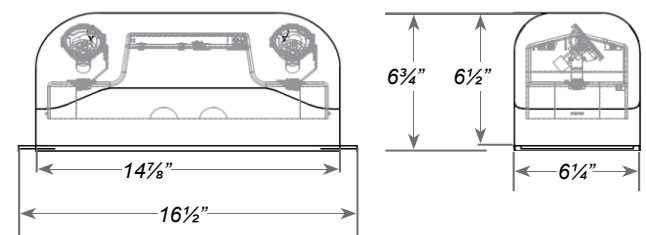

### ORDERING INFORMATION

MODEL	BATTERY VOLTAGE		WATTAGE		HOUSING COLOR		OPTIONS	
SEEINDEMR16	6	6 Volt	15	15 watts	W	White	SDT	Self-Diagnostics
	12	12 Volt	36	36 watts	B	Black	CW	Cold Weather
			54	54 watts			TP	Tamper-proof