

Round Straight Steel Poles

Round straight steel poles are built for ground mounted applications. All poles are non-returnable and non-cancellable.

Lead Time: 4-6 weeks production time

- Detail Specifications:**
- Finish: various powder coat finishes available
 - Material: Straight Steel
 - IP Rating: Wet Location IP65

- Applications:**
- Walkways & Pathways
 - Security Lighting
 - Hospitality, Multi-Family
 - Outdoor Corridors
 - General Outdoor Lighting
 - Residential, Commercial, Industrial

- Shaft Specification:**
- One piece construction, uniformly round
 - Fabricated from weldable-grade carbon steel structural tubing with a uniform wall
 - Conforms to ASTM A-500 Grade B
 - Minimum Yield Strength: 46,000 psi

- Base Plate Cover Specification:**
- Material: Automotive structural grade plastic with UV inhibitor
 - Rust proof and tamper resistant
 - Vibration dampener: included and installed on all poles
 - 25ft + height
- Mounting & Installation:**
- Factory supplied anchor bolt template will be supplied with each pole
 - Anchor bolts and template may be shipped in advance. Please add the anchor bolts and template accessory model# to your PO if needed.
 - Fixture and mounting brackets must be located at the top of the pole for all designs.

Warranty: 3 year finish warranty

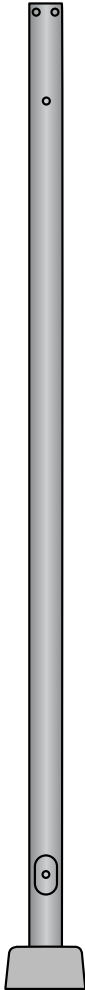

SERIES

Square Straight Steel Series

	Fixture Mounting Arrangement	Finish	Anchor Bolts (Included with pole. Only order if you need it pre-shipped).	Tenon Mounts for Slip Fitter Applications
PRO-RD-SS-8FT-3-11G-AB 8 Feet • 3" 11 Gauge	(Blank)	BZ Bronze	(Blank) No Anchor Bolts	(Blank) No Slip Fitter
PRO-RD-SS-10FT-3-11G-AB 10 Feet • 3" 11 Gauge	No Drill D1	BL Black	PRO-AB-PRESHIP Anchor bolt & template. Shipping charges may apply.	TN-RD-3 3" Pole Adapter
PRO-RD-SS-12FT-3-11G-AB 12 Feet • 3" 11 Gauge	1 Fixture D2@90	WH White		TN-RD-4 4" Pole Adapter
PRO-RD-SS-14FT-3-11G-AB 14 Feet • 3" 11 Gauge	2 fixtures D2@180	GRY Cardinal		TN-RD-5 5" Pole Adapter
PRO-RD-SS-14FT-4-11G-AB 14 Feet • 4" 11 Gauge	2 Fixtures opposite sides D3@90	6403-26307 SLV Cardinal		
PRO-RD-SS-16FT-4-11G-AB 16 Feet • 4" 11 Gauge	3 Fixtures 3 sides D4	6423-GR06-P		
PRO-RD-SS-18FT-4-11G-AB 18 Feet • 4" 11 Gauge	4 fixtures all sides			
PRO-RD-SS-20FT-4-11G-AB 20 Feet • 4" 11 Gauge				
PRO-RD-SS-25FT-5-11G-AB 25 Feet • 5" 11 Gauge				
PRO-RD-SS-25FT-5-7G-AB 25 Feet • 5" 7 Gauge				
PRO-RD-SS-30FT-5-11G-AB 30 Feet • 5" 11 Gauge				
PRO-RD-SS-30FT-5-7G-AB 30 Feet • 5" 7 Gauge				



1 ROUND STRAIGHT STEEL SERIES	EFFECTIVE PROJECTED AREAS			
	80	90	100	120
PRO-RD-SS-8FT-3-11G-AB 8 Feet 3" • 11 Gauge	11.2	8.4	6.2	3.7
PRO-RD-SS-10FT-3-11G-AB 10 Feet 3" 11 Gauge	9.0	6.7	5.0	3.0
PRO-RD-SS-12FT-3-11G-AB 12 Feet 3" 11 Gauge	6.9	5.0	3.9	2.1
PRO-RD-SS-14FT-3-11G-AB 14 Feet 3" 11 Gauge	5.5	3.9	2.9	1.4
PRO-RD-SS-14FT-4-11G-AB 14 Feet 4" 11 Gauge	11.7	8.9	7.1	4.0
PRO-RD-SS-16FT-4-11G-AB 16 Feet 4" 11 Gauge	9.0	6.8	5.3	2.9
PRO-RD-SS-18FT-4-11G-AB 18 Feet 4" 11 Gauge	7.1	5.2	4.0	2.2
PRO-RD-SS-20FT-4-11G-AB 20 Feet 4" 11 Gauge	5.6	4.1	3.1	1.7
PRO-RD-SS-25FT-5-11G-AB 25 Feet 5" 11 Gauge	6.7	5.0	3.7	2.0
PRO-RD-SS-25FT-5-7G-AB 25 Feet 5" 7 Gauge	12.0	9.2	7.5	4.2
PRO-RD-SS-30FT-5-11G-AB 30 Feet 5" 11 Gauge	4.0	2.8	2.0	N/A
PRO-RD-SS-30FT-5-7G-AB 30 Feet 5" 7 Gauge	7.9	6.6	4.8	2.7

EPA RATINGS INCLUDE A 1.3 GUST FACTOR

VIBRATION DAMPENERS INCLUDED AND INSTALLED ON POLES 25' HIGHER

GAUGE	ANCHOR BOLT DIAMETER	BOLT CIRCLE	BASE PLATE
11 Gauge	.75 X 20	8.5	8 SQ X 0.75 Height
7 Gauge	1 X 40	10.0	10 SQ X 1 Height

ANCHOR BOLTS SHOULD BE SET USING FACTORY SUPPLIED TEMPLATES



JOB NAME: _____

TYPE: _____

PART #: _____

NOTES: _____

PRO-RD-SS-8FT-3-11G-AB
PRO-RD-SS-10FT-3-11G-AB
PRO-RD-SS-12FT-3-11G-AB
PRO-RD-SS-14FT-3-11G-AB

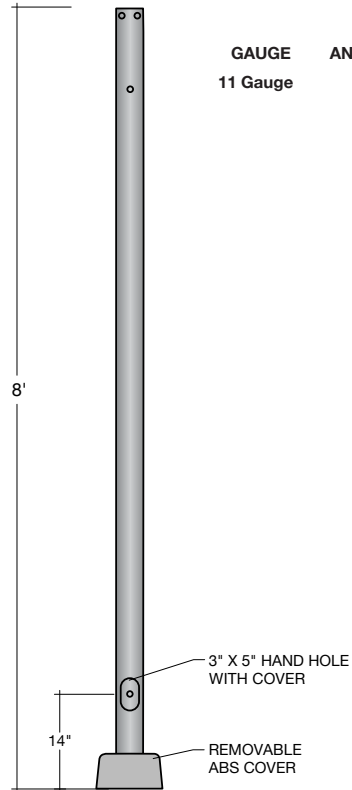

GAUGE	ANCHOR BOLT DIAMETER	BOLT CIRCLE	BASE PLATE
11 Gauge	.75 X 20	8.5	8 SQ X 0.75 Height

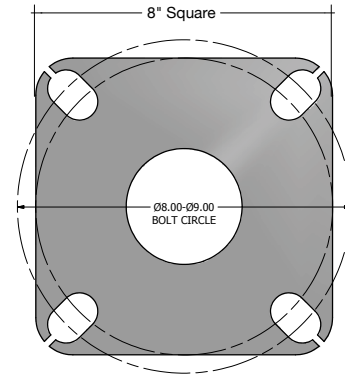

8" X 8" X .75" THICK BASE PLATE

PRO-RD-SS-14FT-4-11G-AB
PRO-RD-SS-16FT-4-11G-AB
PRO-RD-SS-18FT-4-11G-AB
PRO-RD-SS-20FT-4-11G-AB

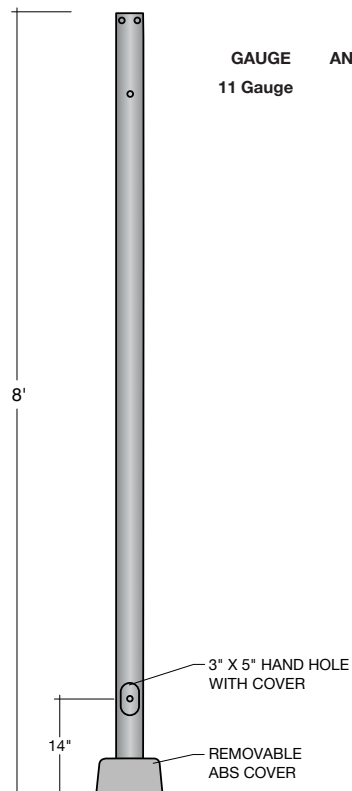

GAUGE	ANCHOR BOLT DIAMETER	BOLT CIRCLE	BASE PLATE
11 Gauge	.75 X 20	8.5	8 SQ X 0.75 Height

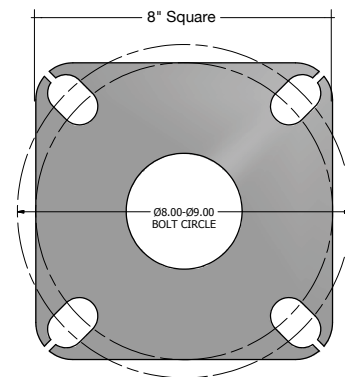

8" X 8" X .75" THICK BASE PLATE



JOB NAME: _____

TYPE: _____

PART #: _____

NOTES: _____

PRO-RD-SS-25FT-5-11G-AB

PRO-RD-SS-30FT-5-11G-AB

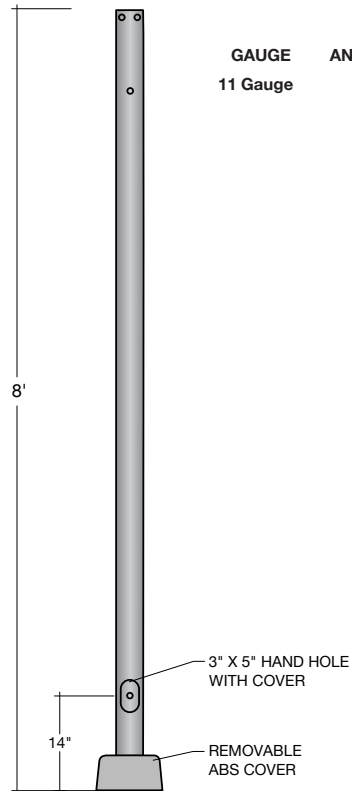

GAUGE
11 Gauge

ANCHOR BOLT DIAMETER
.75 X 20

BOLT CIRCLE
8.5

BASE PLATE
8 SQ X 0.75 Height

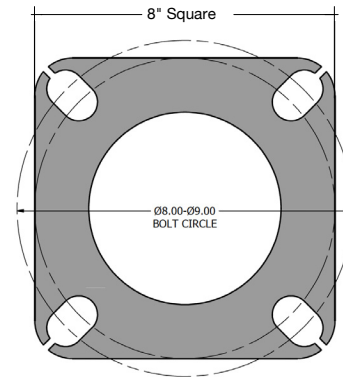

8" X 8" X .75" THICK BASE PLATE

PRO-RD-SS-25FT-5-7G-AB

PRO-RD-SS-30FT-5-7G-AB

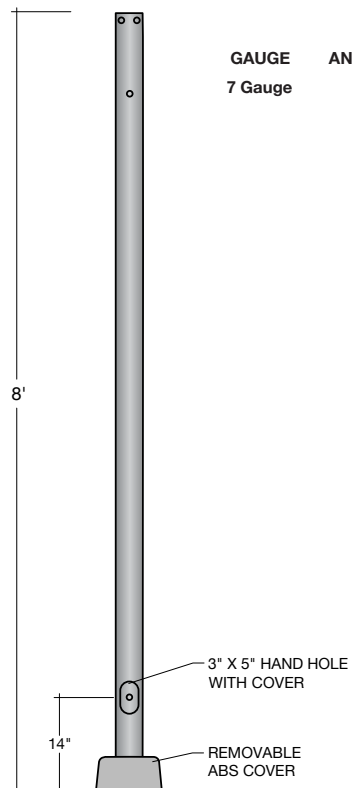

GAUGE
7 Gauge

ANCHOR BOLT DIAMETER
1 X 40

BOLT CIRCLE
10

BASE PLATE
10 SQ X 1 Height

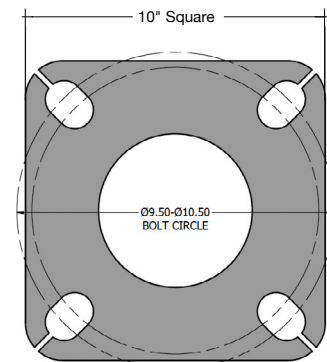

8" X 8" X .75" THICK BASE PLATE